

AT-A-GLANCE PROGRAM



	SATURDAY MAY 30	SUNDAY MAY 31	MONDAY JUNE 1	TUESDAY JUNE 2	WEDNESDAY JUNE 3
7:30	Internal Meetings	Internal Meetings			
7:45					
8:00			8:00	7:30	7:30
8:15				8:30	8:00
8:30	8:30	8:30	8:00	8:30	8:00
8:45					
9:00					
9:15					
9:30					
9:45					
10:00					
10:15					
10:30					
10:45					
11:00					
11:15					
11:30					
11:45					
12:00					
12:15					
12:30					
12:45					
13:00					
13:15					
13:30					
13:45					
14:00					
14:15					
14:30					
14:45					
15:00					
15:15					
15:30					
15:45					
16:00					
16:15					
16:30					
16:45					
17:00					
17:15					
17:30					
17:45					
18:00					
18:15					
18:30					
18:45					
19:00					
19:15					
19:30					
19:45					
20:00					
20:15					

Technical visits to meet at registration desk.



Location of reception and meeting rooms

C FLOOR

Second floor below lobby

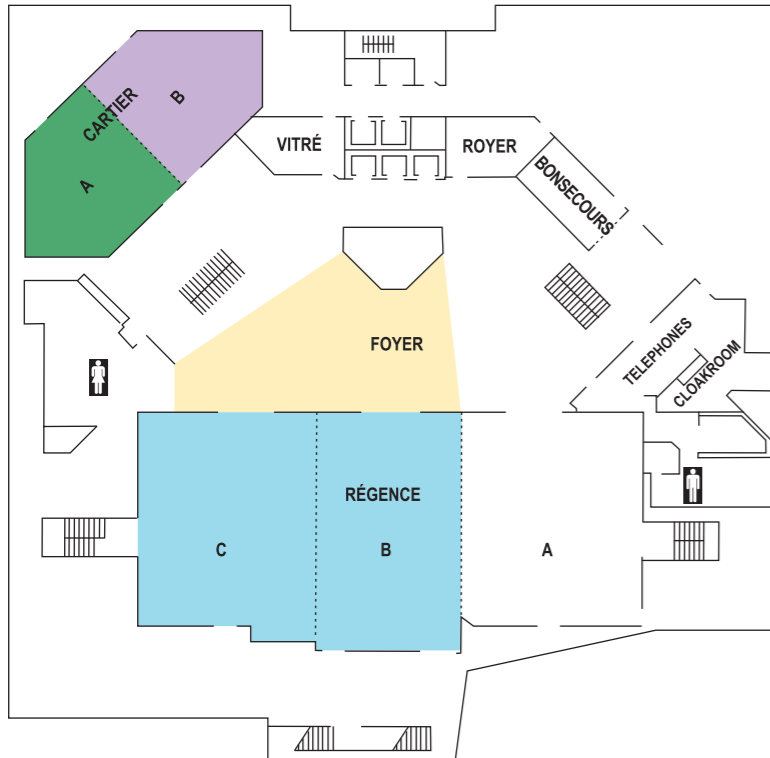

C1 FLOOR

First floor below lobby

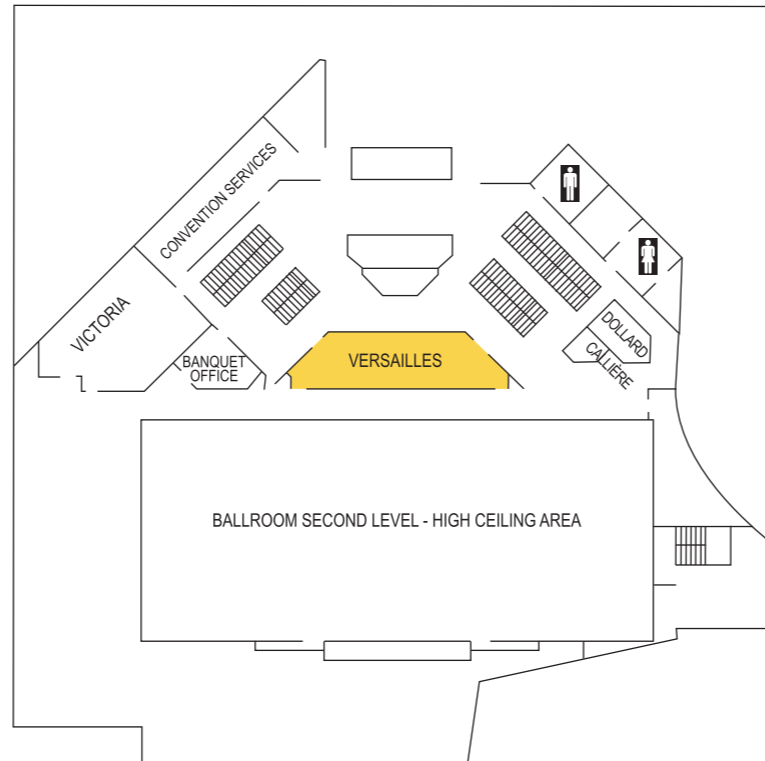

MESSANINE

First floor above lobby

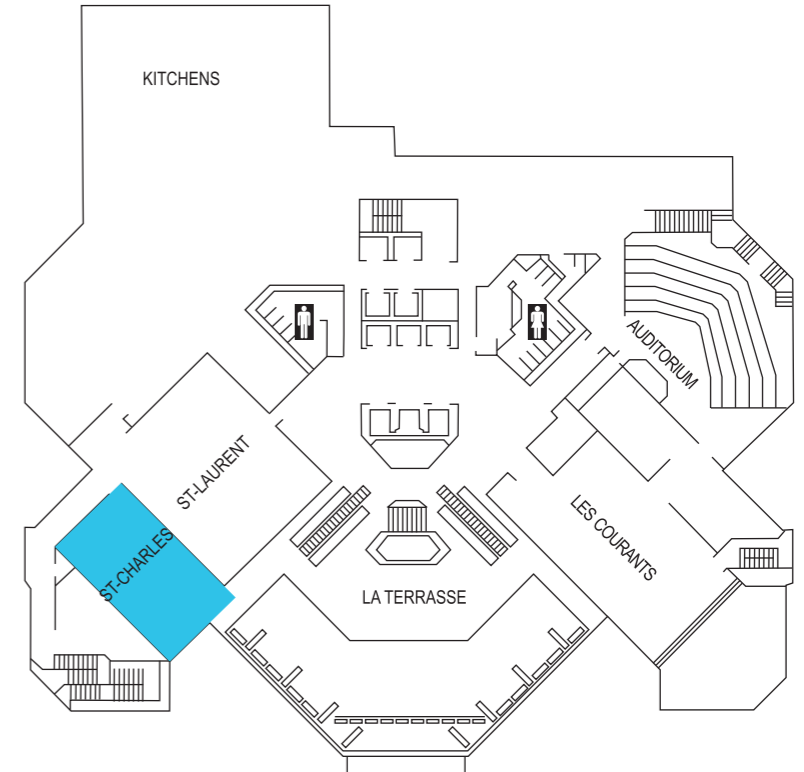

MONDAY, JUNE 1, 2009

SESSION A SUSTAINABLE CITIES (TLC)

- | | | |
|---|---|--|
| 1 | Daniel Egan
City of Toronto | Toronto Road Diets: A Recipe for Bicycle Lanes |
| 2 | Dr. Bruce Hellinga &
Dr. Jeffery Casello | Innovative Tools for Enhancing the Role of Transit in Achieving Sustainable Cities |
| 3 | Michael Hubicki | Roads: Being All They Can Be! |

SESSION B TRAFFIC SIGNAL DESIGN

- | | | |
|---|---|--|
| 1 | Robert Hintersteiner | Predesign of Traffic Signal Intersections |
| 2 | Behzad Rouhieh
Concordia University | Designing for Safer and More Efficient Intersections : A Montréal Case Study |
| 3 | Catherine Morency
École Polytechnique de
Montréal | Véhicules flottants vs GPS : analyse comparative des temps de parcours sur le réseau routier supérieur montréalais (<i>Test Car vs GPS : A Comparative Analysis of Travel Time on Montreal Arteries</i>) |

SESSION C MULTIMODAL STRATEGIES FOR LIVEABLE COMMUNITIES

- | | | |
|---|--|---|
| 1 | Robert Wasnea &
Darryl Mullen
City of Edmonton | Sustainable Transportation in the City of Edmonton |
| 2 | Adrian Witte
Bunt & Associates | Characteristics of Successful Public Bike Systems |
| 3 | Paul Mackay
SAFESTREETS | For a new design approach to create multi-modal collector streets |

SESSION D TRAFFIC SIGNAL SIMULATION

- | | | |
|---|--|--|
| 1 | Kuo Cheng Huang
Concordia University | Simulation of Signalized Intersections, a Cell-Transmission Based Modular Approach |
| 2 | Smith Siromaskul
HDR | Finding a Rythm - Adapting VISSIM for Adaptative Signals |
| 3 | Arun Bhowmick
ISL Engineering and
Land | Micro-simulation of Transit Priority Measures_ Case Study: West High Speed Transit Study, City of Edmonton |

TUESDAY, JUNE 2, 2009

SESSION E UNDERSTANDING PEDESTRIANS

- | | | |
|---|---|---|
| 1 | Sophie Paquin & François Thérien
Direction de santé publique de Montréal | L'Évaluation du potentiel piétonnier : pour concilier transport, santé et aménagement |
| 2 | Rajnath Bissessar
City of Toronto | Pedestrian Scramble Crossings - A Tale of Two Cities |
| 3 | Kelly McGillivray
Peoplecount | People on the Streets - A New Model to Estimate |

SESSION F TRAFFIC SAFETY

- | | | |
|---|---|---|
| 1 | John Robinson
McCormick Rankin Corporation | Using Human factors Science to Make Better Engineering Decision |
| 2 | Smith Siromaskul
HDR | Oregon's Traffic Web Tool - Traffic Data Access and Work Zone Traffic Analysis |
| 3 | Sébastien Drainville
École de Technologie Supérieure | Chronologie et facteurs d'influence de la sécurité routière (<i>Chronology and Influence Factors in Traffic Safety</i>) |

SESSION G WALKABLE COMMUNITIES

- | | | |
|---|---|---|
| 1 | Heather Stevenson
AECOM | Planning for Active-Ways to Health |
| 2 | Dragana Mitic & Brian Patterson | Sidewalk Assessment & Prioritization Study |
| 3 | Michèle St-Jacques
École de Technologie Supérieure | Utilisation des revêtements bitumineux colorés dans les revêtements routiers (<i>Coloured Asphalt Applications</i>) |

SESSION H SAFER COMMUNITIES

- | | | |
|---|---|---|
| 1 | Timothy White
Southern New Hampshire | Summary of Safe Routes to School Demonstration Project |
| 2 | David Arcement
New York City DOT | Traffic Safety Improvements in Murray Hill, New York City |
| 3 | Najib Habesch
Urban Engineers Inc. | The City That Used to Speed - A Case Study From Hartford, Connecticut |

SESSION I PLANNING FOR MAJOR EVENTS

- | | | |
|---|---|---|
| 1 | Richard Kapitan
SPVM | Gestion des déplacements lors des grands événements (<i>Crowd and Traffic Control during Major Public Events</i>) |
| 2 | Marc Desrivières
Ville de Québec | 400e Anniversaire de la Ville de Québec (<i>Québec City 400th Anniversary</i>) |
| 3 | James Campbell & Irene Kerr, VANOC 2010 | Vancouver 2010 |

SESSION J TRAFFIC COLLISIONS AND INCIDENTS

- | | | |
|---|--|--|
| 1 | Elena Zabolotnii
Saskatchewan Highways and Transportation | Black Spot Screening : The Collision Interval Method vs the Shifting Window Method |
| 2 | Eric Salvas
SPVM | Reconstitution de collisions (<i>Accidents Reconstitution</i>) |
| 3 | James Donnelly
Urban Systems LTD | Development of a Safety Improvement Strategy at a Truck Rollover Prone Location |

SESSION K PUBLIC PRIVATE PARTNERSHIP

- | | | |
|---|----------------|-----------------------------------|
| 1 | Sandra Sultana | Québec Ministry of Transportation |
| 2 | Daniel Toutant | Highway 25 |
| 3 | Bob Nairn | NA30 |

WEDNESDAY, JUNE 3, 2009

SESSION L SMART GROWTH			SESSION M SUSTAINABILITY STATE OF PRACTICE CONVERSATION CIRCLE FEATURING		
1	Bosco Tong iTRANS Consulting Inc.	Transportation Smart Growth Planning and Challenges North of the 60th Parallel	1	Nik Luka McGill University	To be determined
2	Dom Nozzi Walkable Streets	Transportation is Destiny : The Road to Ruin	2		
3	Ralph Hessian SHRP 2-TRB	Strategic Highway Research Program 2: Accelerating Solutions for Highway Renewal, Safety, Reliability and Capacity	3		
SESSION N CAR SHARING			SESSION O CONTEXT SENSITIVE DESIGN		
1	Catherine Morency École Polytechnique de Montréal	Autopartage : quels liens entre accessibilité au service, attributs du voisinage et comportements d'utilisation? (<i>Car Sharing : The Influence of Accessibility and Neighbourhood Characteristics</i>)	1	Louis Deschênes Tecsult/AECOM	Le carrefour des avenues du Parc et des Pins : un aménagement durable (<i>Parc/Pine Intersection in Montreal: A Sustainable Design</i>)
2	Kevin McLaughlin AutoShare	The Autoshare Experience	2	Michael Griffith New York City DOT	Trip Generation Rates for Big Box Retail in New York City
3	Yves Dallaire Tecsult/AECOM	L'autopartage et le transport en commun : une combinaison gagnante pour du transport durable (<i>Car Sharing and Transit : A Winning Combination</i>)	3	Paul Bourque PABECO Inc	Stationnements incitatifs sur rues pour utiliser le transport en commun (<i>On-Street Park & Ride</i>)
SESSION P TRANSIT PRIORITY PLAN			SESSION Q NEW AND INNOVATIVE GEOMETRIC DESIGN		
1	Karen Giese & Hansel Wang PTV America	Vancouver's Regional Transit Priority Plan and Implementation Strategy	1	Nadine Lafond Tecsult/AECOM	Continuous Flow Intersection : An Alternative to Grade Separation
2	Stephen Schijns McCormick Rankin Corporation	Arterial HOV Lanes : A Tale of Five Cities	2	Smith Siromaskul HDR	Diverging Diamond Interchange Design 101 - Things to Know Before you Start
3	Karen Giese & Ian Fisher PTV America	Planning of Vancouver's Transit Network with an Operations-Based Model	3	Jan Voss & Eugene Wat Creative Transportation Solutions LTD	The Do's and Don'ts of Installing Traffic Circles - A Case Study